

BACK OF BAR PART A

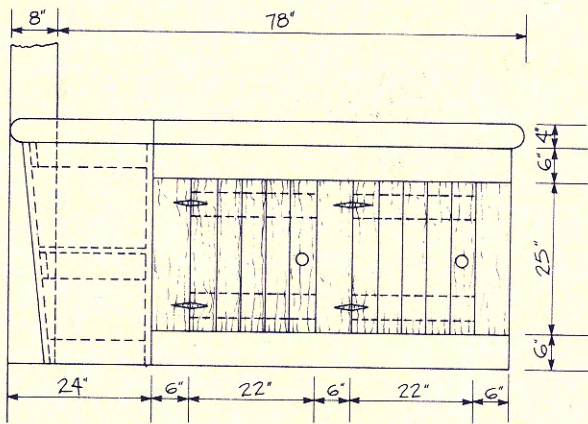

BACK OF BAR PART B PLUS COUNTER

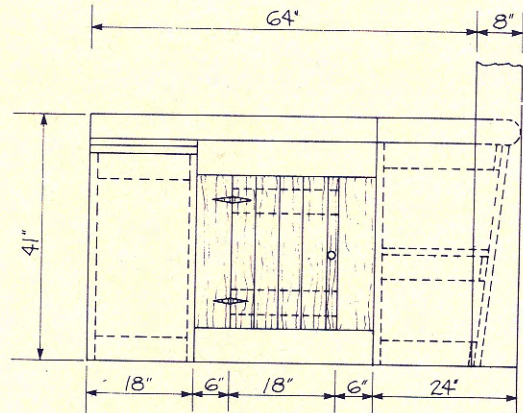

PARTS A AND B OF BAR PLUS COUNTER

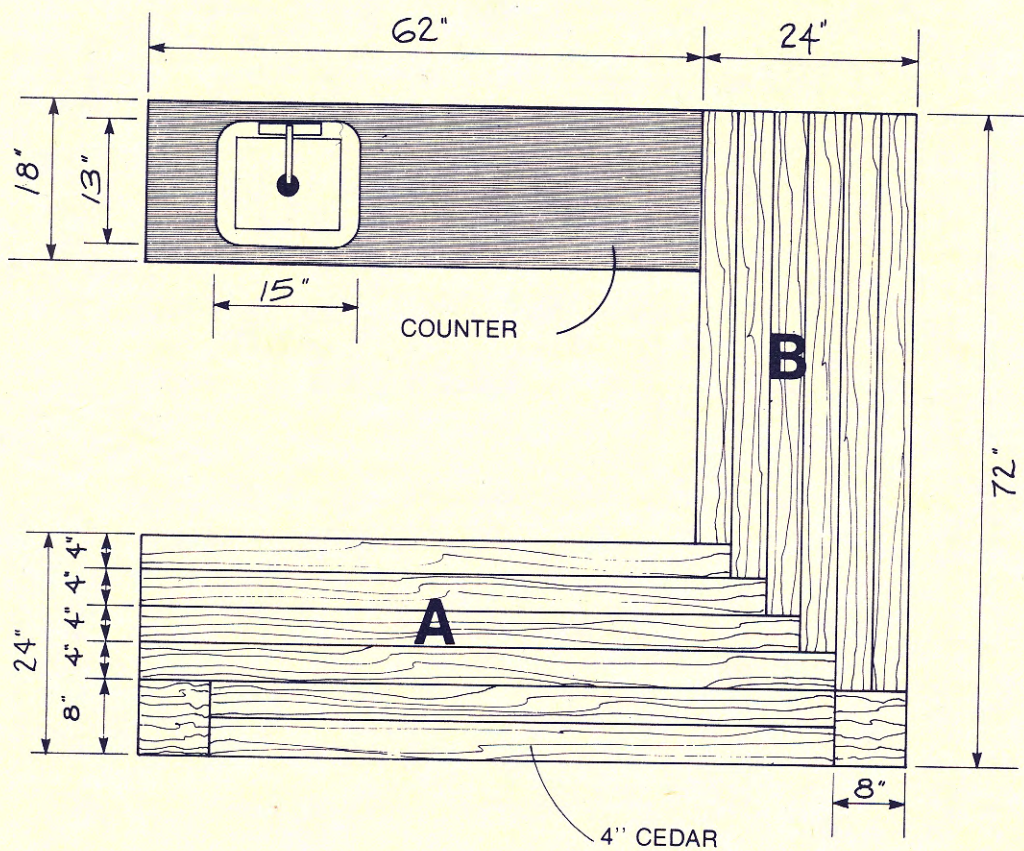

CONSTRUCTION

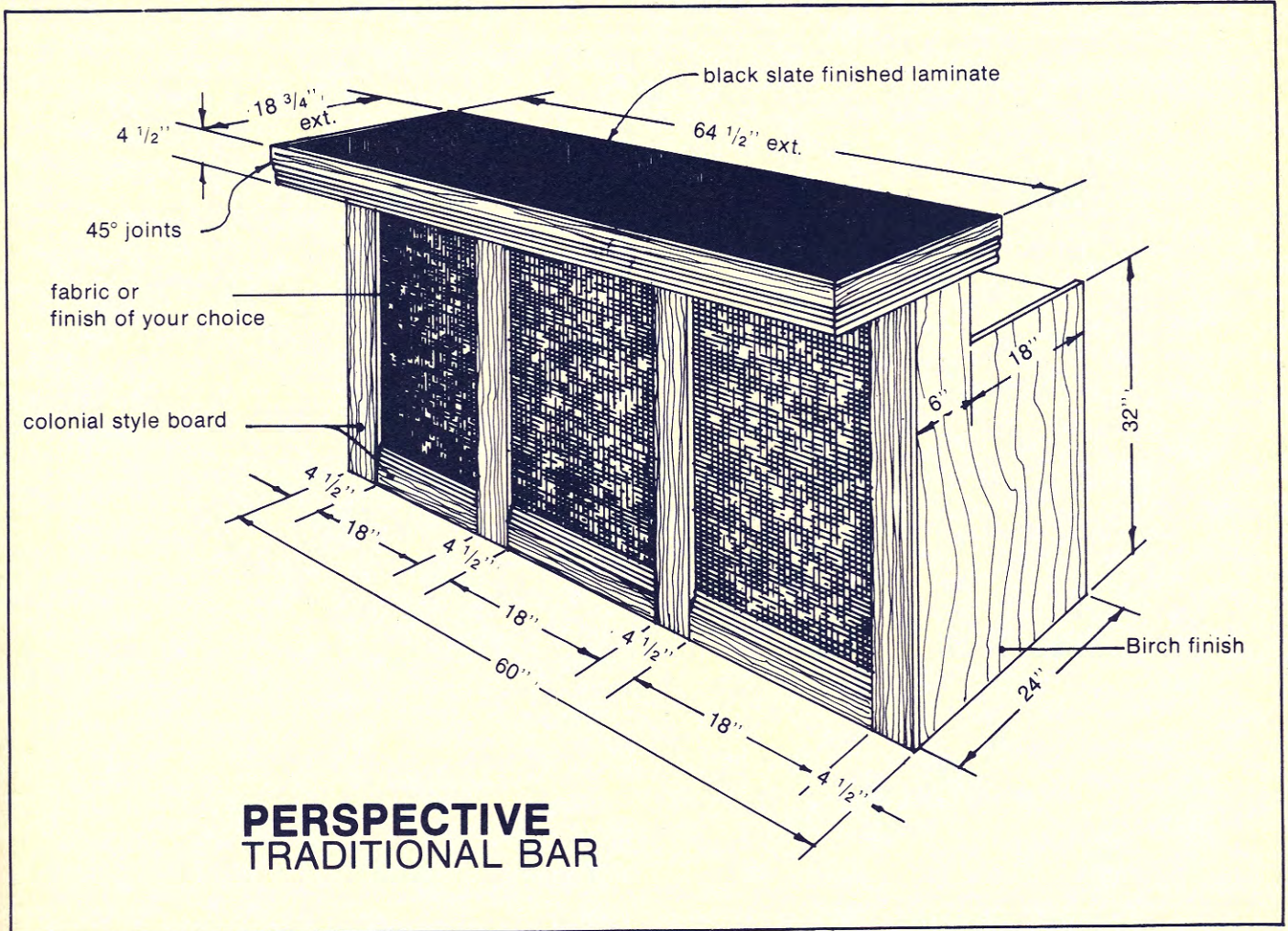

**PERSPECTIVE
TRADITIONAL BAR**

As you can see on the plans, the 4" x 4" s for the counter were crossed where Part A and B meet to form butt joints, but they can be set any number of different ways.

The small counter that holds the sink is now built in the same fashion as the bar and installed. It is made of plywood and you will need to cut a hole in the top for the sink.

The doors are made next. They are made of 3/4" x 4" pieces joined and held together with 2 crossmembers, one at the top and another at the bottom of the door on the inside. Now put the doors in place.

Finishing the wood of the bar is all that's left to do. The spruce boards can be left natural. The cedar counter and the 8" x 8" columns should be sanded well and given 4 or 5 coats of a plastic finish.

Traditional bar

Following are the plans for a traditional bar of a simple design. As for any bar, its construction calls for quite a number of different materials. You will need plywood, thick and standard boards, masonite and laminated plastic as well as guides for the sliding cabinet doors.

This type of bar may be a little difficult to build. The use of colonial boards on the front of the bar set over a fabric base gives it a picture frame look. The sides are plywood and the counter top is covered with laminated plastic, which makes it easy to clean and durable.

This bar, though traditional, will no doubt fully serve its purpose. A few well chosen accessories will complete its furnishings. And due to its relatively small size, its perfect for

someone who has limited available space.

Materials

- 1/2 sheet plywood, 5/8" (birch)
- 5/8 sheet plywood, 5/8"
- 1 5/8 sheets plywood, 1/2"
- 6 studs, 2" x 3" x 8'-0"
- fabric, 60" x 42"
- 2 colonial style boards, 4 1/2" x 8'-0"
- 2 colonial style boards with mouldings, 4 1/2" x 8'-0"
- 1 piece laminated plastic, 63" x 18"
- 1 piece masonite, 50 1/2" x 30 1/2"
- 1 double guide for sliding doors, 10'-0"

Cutting list

- 2 pieces plywood, birch 5/8" x 42" x 24" (left and right sides: make sure birch is on the correct side)